

Connect iPad to Wi-Fi (PEAP)

Step 1: Open Settings → Wi-Fi and select “DTU SciencePark”.

Start connecting to WPA-Enterprise (802.1X).

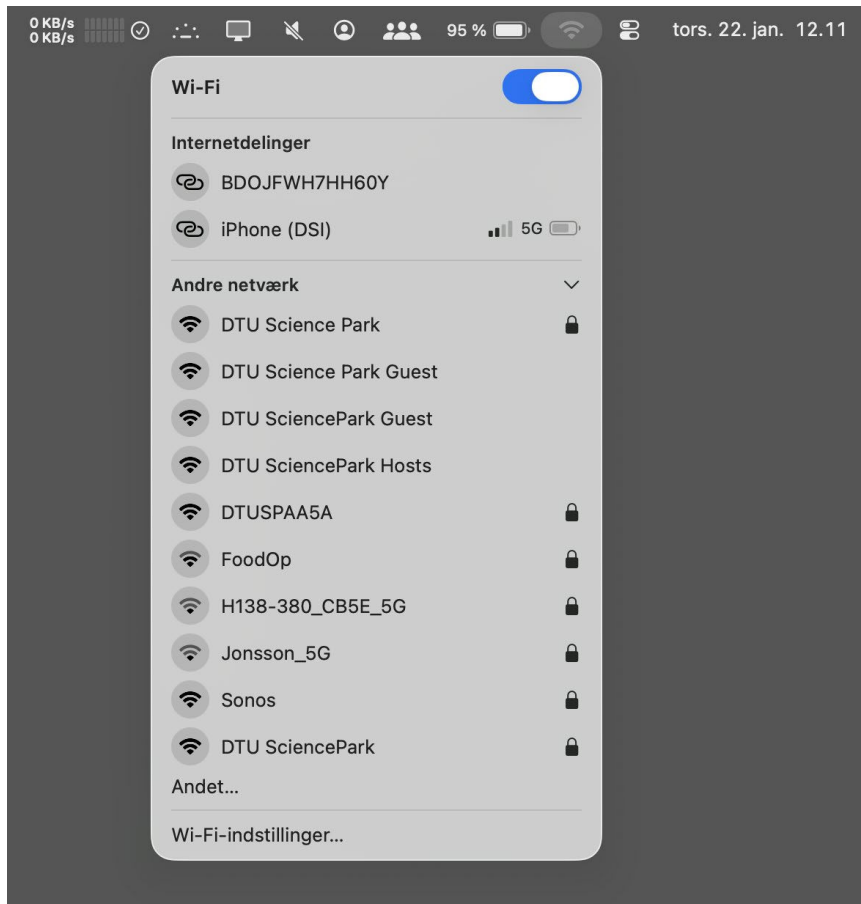

Step 2: Enter Username and Password.

Use the login credentials you received in the welcome email/portal.



Step 3: Verify the certificate and tap “Continue”.

Confirm that the server name is "dtusp-blp-dc01-fauth01.dtusciencepark.dk" and the issuer is "Go Daddy Secure Certificate Authority – G2".

Optionally select “Always Trust ...”.

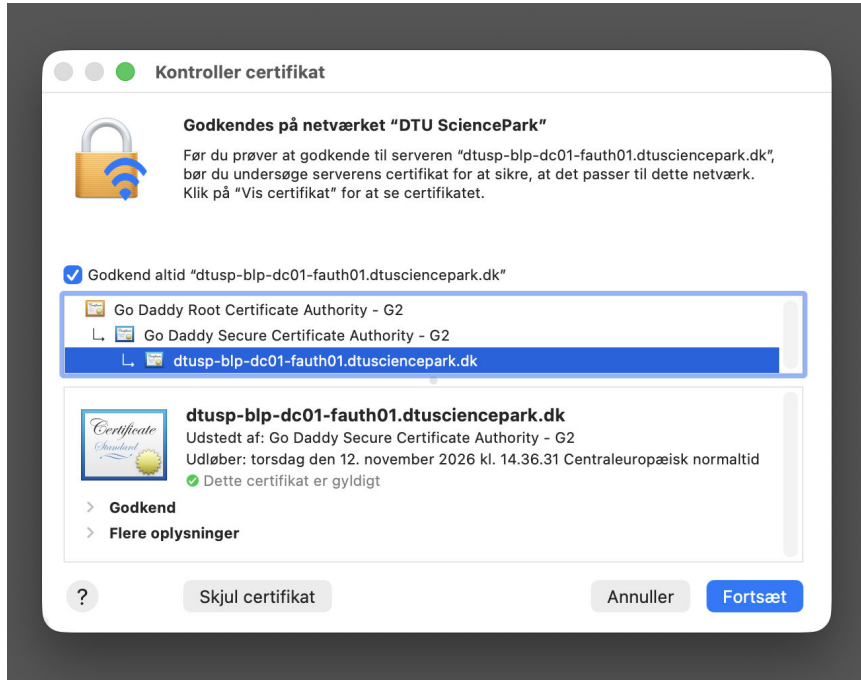

Step 4: Confirm connection.

The network will appear as connected under “Known Networks”. (= “Kendte netværk”)

